

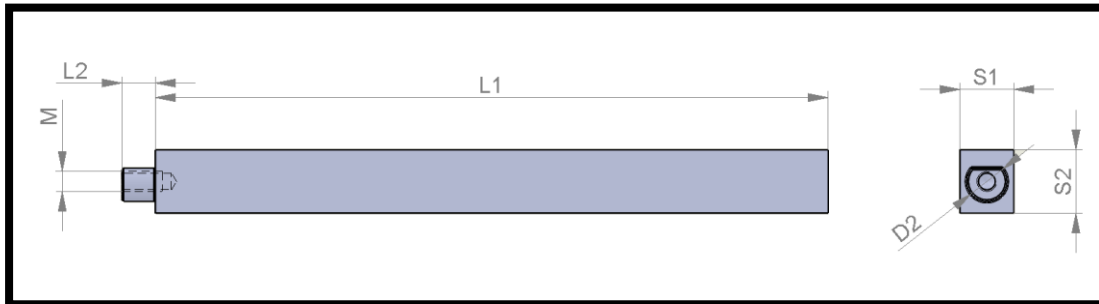

XTREME PROGEAR



Part	D1	D2	L1	L2	M	Material 1	Material 2
KKPHF S-8-100	12	8	100	7,9	M4	1.2343 ≈ 48-50 HRC	SKD61
KKPHF S-8-150	12	8	150	7,9	M4	1.2343 ≈ 48-50 HRC	SKD61
KKPHF S-8-200	12	8	200	7,9	M4	1.2343 ≈ 48-50 HRC	SKD61
KKPHF S-10-150	14	10	150	7,9	M5	1.2343 ≈ 48-50 HRC	SKD61
KKPHF S-10-200	14	10	200	7,9	M5	1.2343 ≈ 48-50 HRC	SKD61
KKPHF S-10-250	14	10	250	7,9	M5	1.2343 ≈ 48-50 HRC	SKD61
KKPHF S-12-150	16	12	150	9,9	M6	1.2343 ≈ 48-50 HRC	SKD61
KKPHF S-12-200	16	12	200	9,9	M6	1.2343 ≈ 48-50 HRC	SKD61
KKPHF S-12-250	16	12	250	9,9	M6	1.2343 ≈ 48-50 HRC	SKD61